

# VILLA MERISA

## PLANS

BEDROOMS

BATHROOMS

ORIENTATION

5

5+2

N/O

PRICE ON REQUEST

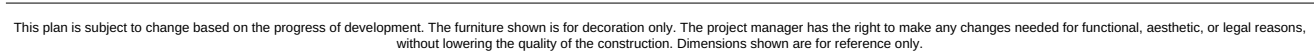

# GROUND FLOOR



This plan is subject to change based on the progress of development. The furniture shown is for decoration only. The project manager has the right to make any changes needed for functional, aesthetic, or legal reasons, without lowering the quality of the construction. Dimensions shown are for reference only.

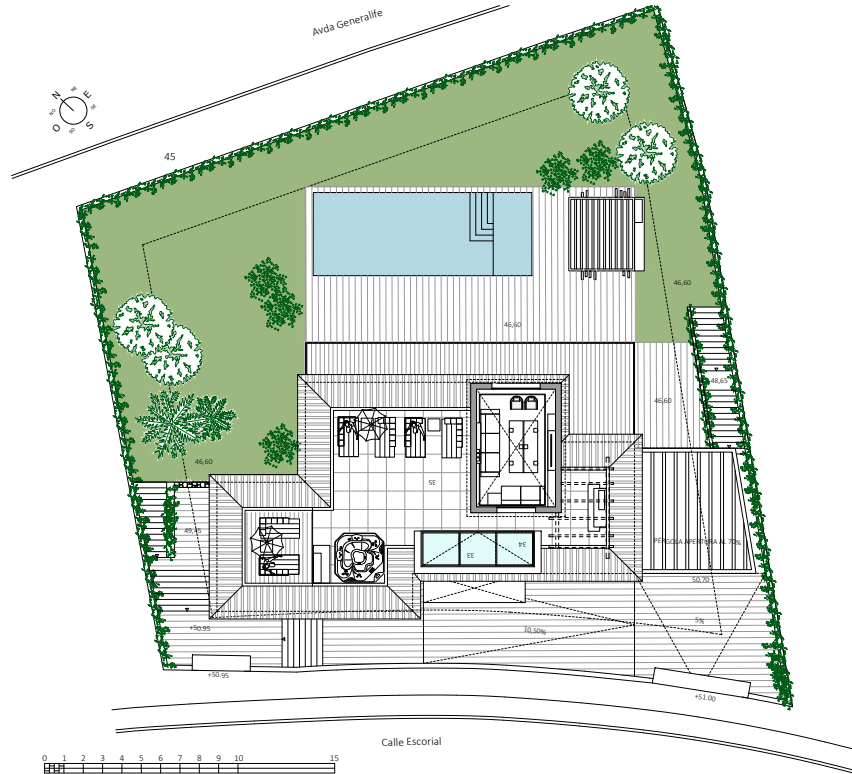

# VILLA MERISA

## PLANS

PLOT	1009,47 m2
------	------------

Garden Area	311,79 m2
-------------	-----------

### AREAS

Enclosed Built Area	458,64 m2
---------------------	-----------

Pool	48,62 m2
------	----------

Terrace Area	403,83 m2
--------------	-----------

### TOTAL BUILT AREA

Total Built Area	862,47 m2
------------------	-----------